

Elevated Landscaped Pedestrian Deck near MTR Kwun Tong Station

Temporary Diversion of Covered Walkway and Closure of Staircase

To facilitate the construction of proposed pedestrian deck, two temporary pedestrian traffic arrangement will be implemented starting from late May 2024.

1. About 30m long existing covered walkway near Kwun Tong Road / Hip Wo Street Rest Garden which connecting Yuet Wah Street and MTR Kwun Tong Station Exit D will be temporary diverted. A temporary walkway will be provided during the arrangement.

2. The lower flights of staircase connecting Yuet Wah Street and Kwun Tong Road will be temporarily closed. During this period, pedestrian can use the staircase at MTR Kwun Tong Station Exit C for access to Kwun Tong Road.

Appropriate directional signs will be provided on site to guide pedestrian.

For more information, please visit our website by scanning the QR code:



近港鐵觀塘站之高架園景行人平台

行人道臨時改道及暫時封閉樓梯安排

為配合興建高架行人平台工程，2024年5月下旬將開始實施兩項臨時的行人交通安排。

1. 近觀塘道／協和街休憩花園旁，通往港鐵觀塘站D出口的一段約30米長的有蓋行人道將實施臨時改道安排。在改道期間請使用臨時行人通道。

2. 月華街通往觀塘道之底段樓梯將於2024年5月下旬開始暫時封閉，期間行人可使用港鐵觀塘站C出口的樓梯來往觀塘道。

有關地點會設置適當的標誌指導行人。

請掃描網站二維碼以獲取更多資訊：



工程通訊 (2024 年 5 月) Newsletter (May 2024)

合約編號：ED/2021/01
近港鐵觀塘站之高架園景行人平台

Contract No.: ED/2021/01
Elevated Landscaped Pedestrian Deck
near MTR Kwun Tong Station



擬建行人平台
Proposed Pedestrian Deck



近港鐵觀塘站之高架園景行人平台

Elevated Landscaped Pedestrian Deck near MTR Kwun Tong Station

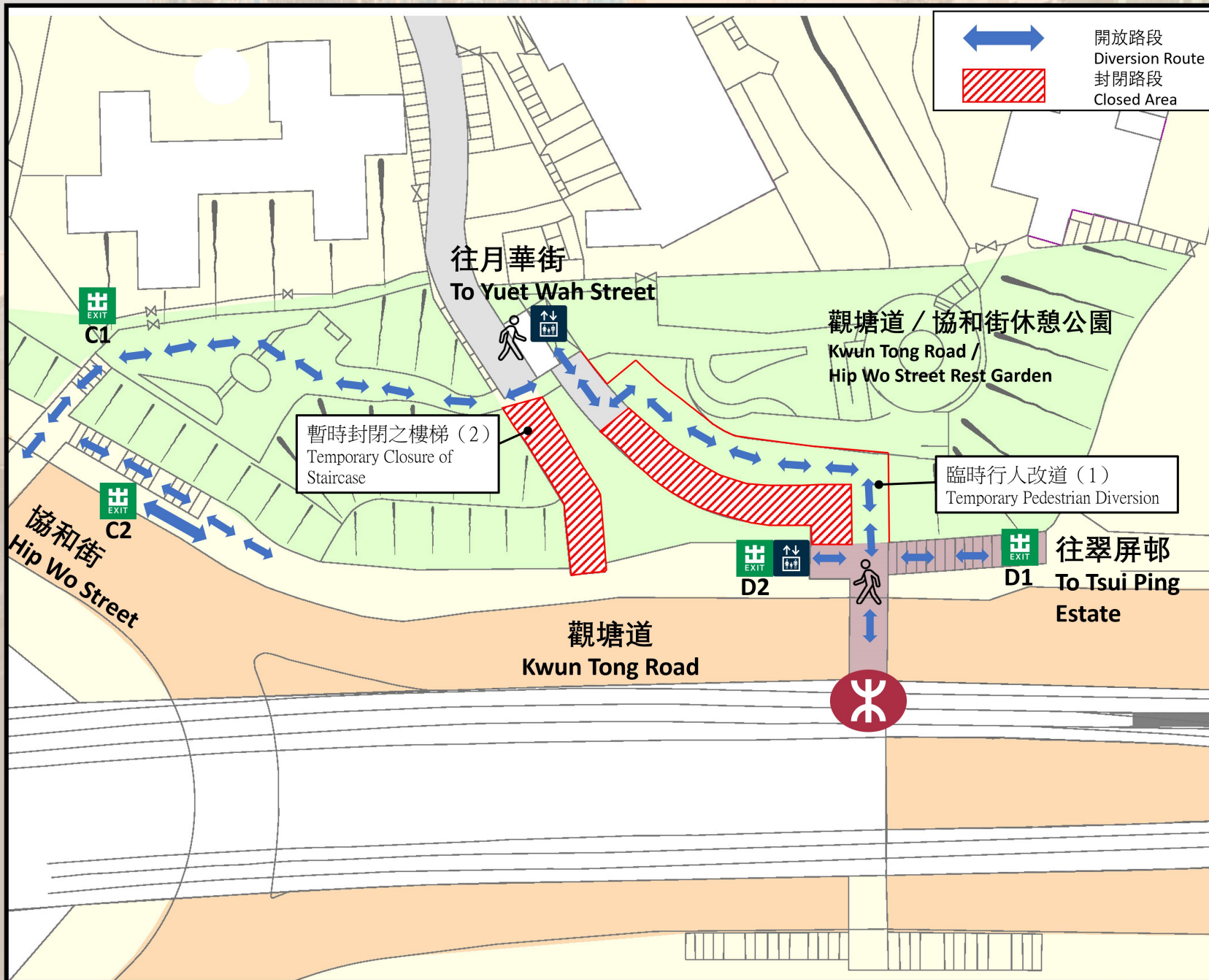

聯絡我們

- 如對閣下造成不便，敬請原諒。
- 如有查詢，請聯絡我們。

24 小時查詢熱線：

5989 0362

Contact Us

- Sorry for any inconvenience caused.
- For enquiry, please contact our 24-hour hotline:

5989 0362

